

SUMMER
'14

GROUP LEADER PACK

**PALM BEACH ATLANTIC UNIVERSITY
XFUGE ON MISSION**

 **FUGE CAMPS**

TABLE OF CONTENTS

CAMP DETAILS

3 ::	WELCOME
3 ::	WHAT IS XFUGE ON MISSION?
3 ::	REGISTRATION POLICY
4 ::	BIBLE STUDY OVERVIEW
5 ::	WHAT TO BRING & WHAT NOT TO BRING
5 ::	DRESS CODE
6 ::	TRANSPORTATION POLICY
6 ::	SPECIAL NEEDS
6 ::	NIGHT LIFE
7 ::	SPONSOR QUALIFICATIONS & RESPONSIBILITIES
7 ::	PARENT PACK
7 ::	PASTOR AND WORSHIP LEADER
7 ::	YOUTH GROUP PROMOTION
8 ::	CUSTOM FUGE T-SHIRTS
8 ::	CHURCH GROUP AND PARENT DEVOTIONS
8 ::	AFTER CAMP BIBLE STUDY & QUIET TIMES
9 ::	MINISTRY TRACK EVANGELISM TRAINING (MTET)
10 ::	PARTICIPANT LIST
10 ::	RELEASE FORM INFORMATION
10 ::	ARRIVAL AT CAMP
11 ::	BRINGING CHILDREN TO CAMP
11 ::	MISSIONS OFFERING
12 ::	CAMP SCHEDULE
13 ::	MORE INFORMATION ON XFUGE ON MISSION
13 ::	PRE-CAMP MATERIALS

LOCATION SPECIFICS

14 ::	CONTACT INFORMATION
14 ::	FACILITY INFORMATION
14 ::	DAMAGES & LOST KEYS
15 ::	CAMPUS MAP

FORMS

16 ::	GROUP INFORMATION FORM
17 ::	AT CAMP REGISTRATION CHECKLIST
18 ::	SPECIAL ATTENTION CARD
19 ::	SPONSOR'S CHILDREN AT CAMP AGREEMENT
20 ::	STATEMENT OF COMPLIANCE
21 ::	FUGE RELEASE FORM

WELCOME

We are so glad you chose to come to FUGE this summer. We hope this information packet will be helpful in your camp planning. To keep up with us all year long, check us out on social media:



"Follow" us!
@fugecamps



"Like" us!
fugecamps



Check us out at
blog.lifeway.com/fuge

WHAT IS XFUGE ON MISSION?

XFuge on Mission is a chance for your students to do missions in the city as a church group. The Lead Host will serve as a master teacher every morning for Bible study for all XFuge on Mission participants. Your group will break into small groups for Bible study discussion, led by the adult sponsors you have provided. The FUGE office will work with you to set up your ministry options in the city.

REGISTRATION POLICY

Before February 1: You may reserve your spot at camp anytime before February 1, 2014 with no deposit.

February 1: A \$50 per person deposit for each reservation is to be paid on or before February 1. If you have already registered, you are required to pay \$50 deposit per person to hold your reservation. Any new or additional reservation made after February 1 will require an immediate \$50 deposit per person. ALL deposits are non-refundable and cannot be applied toward balance due.

May 1 Cancellation Deadline: All cancellations made after May 1 will incur an additional \$50 fee for each person dropped. When cancellations occur, deposits cannot be applied toward balance due.

14 Days Prior to Camp: Final balance must be received 14 days before your arrival at camp. If it is not, your group will be charged a one-time, \$75 fee.

Auto Payment Option: Authorized group leaders may give permission to charge the remaining balance to a church LifeWay account by calling LifeWay Events Registration at 1.877.CAMP.123. This must be done by May 1, 2014. Any adjustments for drops or additions will be applied to the specified account after camp.

Register for 2015: The best way to reserve the week and location of your choice for 2015 is by going online at fuge.com on June 1. You will have an opportunity to register while you are at camp. There will be a time where the director will go over this information. Consult with your students and adults beforehand to be prepared for this time.

REFER-A-FRIEND: Tell a friend to register for FUGE by calling 1.877.CAMP.123. Have them mention FC14NEW to get their free spot. Make sure they mention your church's name and address as their referring church so you get your free spot! (Church you refer must not have attended FUGE since summer 2010).

BIBLE STUDY OVERVIEW

Please take time to discuss and study the theme with your students

BE

Living as the Body of Christ in an Unbelieving World

Life Questions: Why should we commit our lives to being and serving the Church? Why and how are we to live as humble servants? What does true community look like in Scripture? How can we boldly live for Christ and share Him with others?

Day 1 - BE HIS.

Teaching Aim:

Students will learn about the relationship between Christ and the Church. They will be encouraged to commit their lives to the Church as Christ followers and submit to His authority and will realize the power that comes in being His.

Scripture: Colossians 1:18-22; Matthew 16:25; Acts 3:1-16

Key Verse: Colossians 1:18

Day 2 - BE LAST.

Teaching Aim:

Students will discover Christ as the perfect servant and the significance of humility within His Church. They will recognize the necessity of being last which requires a life of sacrificial service and great generosity.

Scripture: Philippians 2:3-11; John 13:3-17; Acts 4:32-35

Key Verse: Philippians 2:3

Day 3 - BE REAL.

Teaching Aim:

Students will recognize the necessity of authentic community within the body of Christ. They will experience freedom and growth when they choose to be real with fellow believers about their faith.

Scripture: Acts 2:42-47; Colossians 3:12-17; 2 Timothy 1:6-12

Key Verse: 2 Timothy 1:7

Day 4 - BE BOLD.

Teaching Aim:

Students will look at how scripture calls us to be bold and unashamed of Christ. They will discover how the early church acted with boldness and be challenged to live as disciples and disciple-makers.

Scripture: Acts 1:8; Acts 4:7-15; Acts 8:26-40

Key Verse: Acts 1:8

WHAT TO BRING

- Linens, towels, pillows, blankets
- Water bottle you can refill and carry with you
- Closed toe, closed heel shoes (for outdoor activities)
- Bible, notepad, and pen
- Toiletries such as toothbrush and shampoo
- Sun protection
- Spending money for snacks, camp store, and missions offering (optional)
- Summer clothing (see dress code below)
- Theme night clothing

WHAT NOT TO BRING

- Alcohol, tobacco, illegal drugs, fireworks, water guns, or any kind of weapon
- We recommend no cell phones, iPods, playstation portables or other gaming devices, roller blades or skateboards. If students do bring cell phones or iPods, please ensure these are not distractions at camp.
- Items that may be used for pranks such as water balloons, shaving cream, silly string, etc. Pranks are not allowed at camp. Your church will be charged for any damages or issues related to clean up.

DRESS CODE

Make sure your student does NOT pack anything that:

- Advertises alcohol, tobacco, or illegal drugs.
- Explicitly or implicitly promotes racism, sexism, or hatred of any group or person.
- Explicitly or implicitly refers to sexual actions or situations.
- Has spaghetti/small straps or open back, except for sleepwear.
- Is excessively short or tight fitting.
- Has writing or lettering on the caboose/backside/bottom/fanny (you get the picture).

While at camp, we ask that students:

- Wear sleeved t-shirts (no tank-tops) and modest shorts (when hands are extended to the back or the front, finger tips must touch fabric).
- Wear closed-toe and closed-heel shoes while on ministry site (and during Mega Relay).
- Wear modest, one-piece bathing suits or two-piece suits covered with a dark colored t-shirt, if participating in water activities.
- Wear modest shorts, pants, jeans, or dresses for worship. Dresses with spaghetti or small straps, open backs, and excessively short lengths are unacceptable (when hands are extended to the back or the front, finger tips must touch fabric).
- Not dress in a way that calls attention to underwear (sagging your pants, rolling down your waistbands, etc.).

Some Painting, Construction, and Yardwork participants may be asked to wear long pants while working at certain ministry sites.

Adult leaders have the responsibility of modeling and monitoring their group to ensure students are dressing appropriately.

TRANSPORTATION POLICY

Groups must provide adequate and appropriate transportation and drivers for students to get to ministry sites while attending XFuge on Mission.

If your group comes on a chartered bus to XFuge on Mission and you plan on using that charter bus as your transportation to ministry site, you will need to secure lodging for the bus driver. The bus driver is welcome to be considered as one of your adult chaperones, as long as they will participate in supervising your students and you trust them to do so. If this is the case, you can just register him/her as an adult sponsor in your group numbers. If you do not wish to have the bus driver serve as an adult chaperone, you will need to make housing arrangements.

SPECIAL NEEDS

FUGE takes the special needs of students and adults seriously. Meeting your needs and setting up your group for a great week of camp is important to us. While we understand the spiritual need for your students is great, we would like to specifically know about physical and emotional needs.

If one of your students has a special need that should be handled **before** camp starts, including wheel chair accessibility, hearing/sight impairment, food allergies, etc., please call our camp toll-free line (1.877.CAMP.123) and share this with our events registration team so it can be handled properly. The special need can also be shared with us via email at fuge@lifeway.com. **Please let us know at least two weeks prior to your arrival.**

If your student's need should be known by our staff at camp, you have the option of completing a "Special Attention Card" for your student so this need can be addressed by the FUGE staff. You can print and complete this card before camp or fill it out on registration day at camp. You can find a copy of this card in the Forms section of this document.

NIGHT LIFE

Make sure your students pack clothes/items for our dress up Night Life on the second full day of camp!

First Full Day - Participants will take part in an indoor, fun game called "So You Wanna BE A..." within church groups. This game will involve some students on stage and all church groups off stage. Students and adults should come dressed this night as what they want to BE when they grow up or what they wanted to BE as a child.

Second Full Day - Extended free time will be available on this afternoon with games, tournaments, recreation activities and more on campus. Feel free to venture off campus for entertainment options or a visit to the beach! No Night Life will be held this night.

Last Full Day - MEGA RELAY! Get your game faces on and come ready to compete for the FUGE Cup!

SPONSOR QUALIFICATIONS & RESPONSIBILITIES

- In order to provide the best atmosphere and supervision, we ask all groups to bring 1 male sponsor for every 5 boys, and 1 female sponsor for every 5 girls. Due to safety and liability concerns, FUGE will not allow students to be without adult supervision in housing areas.
- All adult sponsors must be at least 19 years old; basically, someone who has been out of high school for at least one year. We encourage each church to select these sponsors at their own discretion.
- All adult sponsors must meet the requirements set forth in the Statement of Compliance located in the Forms section.
- Adult sponsors are responsible for monitoring the dress code (check your students at breakfast) and behavior of your students. Adult sponsors should model appropriate dress code and behavior.
- Encourage participation and promptness by setting an example.
- Ensure students are having a daily quiet time, preferably before Morning Celebration (quiet time materials are provided at camp).

PARENT PACK

This is a condensed version of the Group Leader Pack for you to email or print for the parents of your students. **CLICK HERE:** http://fuge2014.s3.amazonaws.com/PP_PBA.pdf

PASTOR & WORSHIP LEADER

FUGE Camps offers the best camp pastors and bands/worship leaders available. Camp pastors are dynamic and relevant. Bands and worship leaders are musically talented and gifted in leading worship. And, all of these folks are interested in investing in your students. Go to www.fuge.com for pictures and biographies.

YOUTH GROUP PROMOTION

We have created a resource to help you promote camp to your students. This resource is a one-night promotional outline to be used during a mid-week meeting. The outline includes an activity similar to a camp Night Life, videos, testimonies, and a fellowship time. We have crafted it in such a way that you can pick and choose elements in order to make it the most beneficial for your students. Check it out under the Promotional Resources tab on www.fuge.com!

CUSTOM FUGE T-SHIRTS

Want a t-shirt all of your students can wear together while at camp? We've got you covered with customizable t-shirts available at great prices! Our team at LifeWay has put together some cool t-shirt designs for summer 2014. Go online, pick a design, then choose the t-shirt and imprint color! How easy is that?

For more information about this awesome offer, check out <https://www.lifewaycustomfuge.com/>

CHURCH GROUP & PARENT DEVOTIONS

Church Group Devotion is a time for each church group to be together in the evenings to debrief the day. This time usually lasts one hour. The group leader needs to determine what should be discussed or taught. The FUGE office provides devotions for this time which can be found on www.fuge.com after April 1. Print this material and bring it to camp with you, if you choose to use it.

Parent Devotions are also available on www.fuge.com after April 1. This resource is for you to give parents so they can study what students are learning in Bible study.

AFTER CAMP BIBLE STUDY // QUIET TIMES

FUGE Camps provides an After Camp Bible Study designed to follow the camp experience. Use the three-session Bible Study as Sunday School curriculum or for your mid-week events. These can be found on www.fuge.com beginning April 1. Your students will have after-camp quiet times in their Quiet Time Guide. Encourage them to use these devotions in the days following their camp experience.

LifeWay Student Ministry offers many resources including ongoing curriculums, short term studies, girl's and guy's specific studies, DNow curriculums, and a daily devotion magazine. Check out www.lifeway.com/students.

XFUGE ON MISSION MINISTRY TRACKS

If your group is registered for XFuge on Mission the Site Director for FUGE will contact you in the spring (no later than May 1) to talk with you about your church's needs for serving. You will have the choice to do ministry each day you are at camp, or participate in ministry all but one day and use that day to do team building, sightseeing, or something on the FUGE campus. You are responsible for transporting your students to ministry site as well as supervising them while they are there.

Your choices for the type of ministry your students/church can participate in are:

Children's Ministry

This ministry track involves working with children in a variety of settings. These tracks could include Vacation Bible Schools, Backyard Bible Clubs, Day Camps, and other site-specific work with children. The purpose of this track is to minister to children, providing your students with the opportunity to teach and lead children in telling Bible stories, making crafts, and playing games.

Social Ministry

This ministry track involves a variety of ministry opportunities for meeting the physical, emotional, mental, and spiritual needs of people. This track ministers to the following populations and organizations: mentally/physically handicapped centers, homeless shelters, soup kitchens, food banks, clothing closets, furniture distribution centers, refugee ministries, centers for teaching adults and children English as a second language (ESL), prison ministries, Baptist centers, Salvation Army sites, and other community organizations with like purposes.

Painting, Construction, and Yardwork Ministry

Students in this track will spend their week building houses, roofing, repairing, cleaning, painting, and doing yardwork. These tracks work with various organizations such as Habitat for Humanity and the local housing authorities to meet the physical needs of churches, schools, families and individuals. Students in this track will be encouraged to share the love of Christ with people they are working for and with people they encounter through their work.

MINISTRY TRACK EVANGELISM TRAINING (MTET)

To aid in students' preparation for ministry and sharing their faith, FUGE Camps provides you with an MTET teaching plan that will help students know how to begin meaningful conversations, share their own personal story and share the gospel while on ministry site.

Plan to cover the MTET plan with your students before coming to camp. The plan is written to be covered in three 20-minute sessions or all together in a one-hour session.

Click on this link to download the MTET plan: http://fuge2014.s3.amazonaws.com/MTET_for_GL.pdf

PARTICIPANT LIST

In order to prepare for the week, we need to know your students names and ages before they arrive at camp.

Click on the link below for this Participant List Excel document. Please complete the Excel grid and email it to **palmbeachfuge@gmail.com** two weeks prior to your arrival at camp.

If you do not complete and email this grid to camp, you will be asked to complete it upon arrival at camp. Having done this before camp will ensure a faster and more efficient registration process.

CLICK HERE: http://fuge2014.s3.amazonaws.com/2014_ParticipantList_GENERAL.xlsx

RELEASE FORM INFORMATION

Every person coming to camp (adult sponsors and students) needs to bring two FUGE Release Forms (with a copy of your insurance card attached to both); one original notarized form will be given to camp staff plus a photocopy for you to keep with you while at camp. You can find the FUGE Release Form in the Forms section of this document.

ARRIVAL AT CAMP

When you arrive to camp this summer, you will need to bring the following with you (all of which are included in the Forms section of this document):

1. **Two FUGE Release Forms.** One notarized original and one copy with photocopies of insurance cards attached for each camper and sponsor. Please bring them separated into two sets in alphabetical order by last name. The set of notarized originals will be turned in upon arrival to FUGE and the other set of copies is to be kept with the group leader at all times.
2. **Group Information Form.** This form provides age breakdown and male/female ratios.
3. **At Camp Registration Checklist.** This is for you to ensure completion of all registration stations.
4. **Statement of Compliance.** This form ensures adult sponsors have been properly screened.

Registration will take place between 1pm and 4pm. Look for banners to point you to FUGE Registration. You should not have to bring payment with you, unless you have changes at the last minute, as payments are due two weeks prior to arrival at camp.

Giveaway t-shirts will be distributed and church group photos will be taken during the registration process. Please be prepared to order your church group photos by the morning of the first full day of camp. Photos are size 8x10 (\$6 each) and 10x15 (\$8 each). If you order 10 or more, you get 1 free 10x15 photo FREE! Check with your students and sponsors to determine how many serious or silly pictures they would like to order.

BRINGING CHILDREN TO CAMP

We want you to be able to spend more time with the ones you love during your busy summer. Children too young to participate in our camp programming (completed 5th grade or younger) can join you at camp with the following parameters:

- **Meals/Bed = full price**
- **No meals/No bed = no charge**

Children at camp must have adult supervision at all times. Children must attend ministry site with their parents. There are some sites that are not suitable for young children. We recommend participation in Children's Ministry tracks, however final decision will be at the discretion of the Site Director.

Children at camp should not attend a student Bible study. We want your family to experience worship together, but not at the expense of everyone else. We ask that you please take your child out of the service if they are a distraction to others. Please also consider the needs of your students and ensure enough adults accompany your group to build relationships and focus on their camp experience.

Please note that while we welcome your children to camp, the camp program is not designed for their comfort. We cannot make arrangements for your child to have quiet hours for naps.

Please include any children on the Participant List and email fuge@lifeway.com to let us know prior to arriving at camp. Any parent who brings a child to camp will also be required to fill out the Sponsor's Children at Camp Agreement form located in the Forms section of this document.

MISSIONS OFFERING

FUGE Camps will again partner with the North American Mission Board (NAMB) and the International Mission Board (IMB) to support missions both here at home as well as around the world.

The portion of the missions offering for NAMB will assist in two areas of focus: SEND North America and Current Canada.

Through **SEND North America**, NAMB helps to mobilize churches and individuals by providing missions opportunities throughout North America. NAMB will train and implement church planting strategies to reach 5 regions and 32 cities across North America with the message of God's love, mercy and redemption through Christ. For more information about SEND North America, check out www.namb.net/overview-why-send/

Another area of missions service will be through Current Canada. Current Canada is a summer internship program for students to partner with church planters across Canada to impact a culturally diverse nation that is less than 10% evangelical Christian. For more information on Current Canada, please visit www.currentcanada.net

The portion of the missions offering for IMB will provide vital ministry funds for work in **Sub-Saharan Africa** as well for missionaries all over the world hosting International World Changers projects. For the second year in a row, the largest part of the offering will be used to reach out to the **Karamojong** people of northern Uganda. For more information and to keep up with the work being done in Sub-Saharan Africa, please go to www.fugeforafrica.com

CAMP SCHEDULE

Opening Day

1:00 – 4:00 PM	Registration
5:00 PM	Dinner
6:30 PM	Opening Celebration
7:30 PM	MTET/Track Time Planning
10:00 PM	Church Group Rally
10:15 PM	Church Group Devotion
11:00 PM	In Rooms
11:30 PM	Lights Out

Day 1 of Camp

7:00 AM	Breakfast / Quiet Time on your own or with church group
8:15 AM	Morning Celebration
9:00 AM	Master Teacher Bible Study & Discussion
10:15 AM	Depart for Ministry Sites
3:15 PM	Hang Time
5:00 PM	Dinner
6:30 PM	Worship
8:00 PM	Church Group Devotion
10:00 PM	Night Life
10:30 PM	Hang Time
11:00 PM	In Rooms
11:30 PM	Lights Out

Day 2 of Camp

*Morning Schedule is the same as Day 1	
3:15 PM	Extended Free Time
5:00 PM	Dinner (For those staying on campus)
8:00 PM	Worship
9:30 PM	Church Group Devotion
11:00 PM	In Rooms
11:30 PM	Lights Out

Day 3 of Camp

*Morning Schedule is the same as Day 1	
4:00 PM	Mega Relay
5:00 PM	Dinner
7:00 PM	Worship
8:30 PM	Church Group Devotion
10:00 PM	Hang Time
11:30 PM	In Rooms
12:00 PM	Lights Out

Closing Day

7:00 AM	Breakfast / Quiet Time on your own or with church group
8:30 AM	Bible Study
9:45 AM	Closing Celebration
10:45 AM	Churches Depart

MORE INFORMATION ON XFUGE ON MISSION

More specifics on the XFuge on Mission schedule are:

Opening Night

- At the end of Opening Celebration during dismissal, send one adult sponsor to the front with your flag.
- Your host will take you to a central location to meet the camp pastor and worship band.
- Your host will take you to your bible study location. Group leaders will lead a short introduction to camp, ministry track evangelism training, and ministry track planning.
- Your group can participate in a Camp Mixer with other XFuge on Mission, XFuge, and Centrifuge campers.

Morning

- Quiet Time and breakfast with your group begins the day followed by Morning Celebration, a time for the whole camp to come together.
- Note: Before Morning Celebration, make sure your group's driver picks up lunches and coolers for your group.
- Daily announcements will be shared by your host.
- Our XFuge Lead Host will teach the scripture passages each day for approximately 15-20 minutes. (This is completely optional)
- Following this time, XFuge on Mission participants will debrief and discuss the Bible study for that day. This debriefing time is led by you or adult sponsors from your own church group.
- An overview of Bible study is located on page 4 and a discussion guide will be emailed to you.
- Gather any needed supplies and equipment and head off campus to ministry site.
- XFuge on Mission participants will eat lunch on site.

Afternoon

- XFuge on Mission participants will be on ministry site.

Evenings

- All students will be together for evening activities: Worship, Church Group Devotion, Night Life(optional) and Hang Time.

PRE-CAMP MATERIALS

The FUGE office will email all of the XFuge on Mission churches the following:

- 2014 Bible Study Discussion Guide. Supplies are NOT provided for activities in the motivation and application sections of the guide.
- Ministry Track Notebook - guide for how to run a ministry site.

If you do not receive this email by April 1 please contact fuge@lifeway.com.

PALM BEACH SPECIFICS

CONTACT INFORMATION

Mailing and Physical Address:

Palm Beach Atlantic University

Attn: FUGE Camps (please write church and camper name on all mail)

901 S. Flagler Drive

West Palm Beach, FL 33401

FUGE Camp Cell Phone Number (not active until May 26): 615.852.5756

FUGE Camp Email Address (not active until May 26): palmbeachfuge@gmail.com

Before May 26 Contact:

Events Registration: 1.877.CAMP.123 or fuge@lifeway.com

Coordinator - Kyle Cravens: 615.251.3823 or kyle.cravens@lifeway.com

FACILITY INFORMATION

Palm Beach Atlantic University Phone Number: 888-468-6722

Palm Beach Atlantic University Website: www.pba.edu

Housing: Dorm Style (2 to a room)

Bath: Suite Style (shared between 2 or 4 rooms)

Linens: Not Provided

Amenities: Ping pong, pool tables, vending machines, laundry facilities, snack shop, basketball courts, fitness center, racquetball courts, sand volleyball, free wi-fi, and only one mile to the beach!

Average Weekly Attendance: 300-400

AREA ATTRACTIONS:

City Place - 700 S Rosemary Avenue, West Palm Beach, FL 33401 - Shopping, dining, movie theaters

Rapids Water Park - 6566 N Military Trail, West Palm Beach, FL 33407 - 30 acres of water fun-35 water slides, wave pool, lazy river

Beaches - Peanut Island, DuBois Park, Juno Beach Park, Ocean Reef Park, R.G. Kreusler Park and many more-some within walking distance

Wildlife - McCarthy's Wildlife Sanctuary, Palm Beach Zoo, Lion Country Safari, Grassy Waters Nature Preserve

Parks - Okeethee Park, Centennial Square Park, Dyer Park

DAMAGES // LOST KEYS

Please be aware that your group is personally responsible for damages to any facilities including but not limited to the dorm room your group occupies. You will also be asked by the facility to pay for any lost keys.

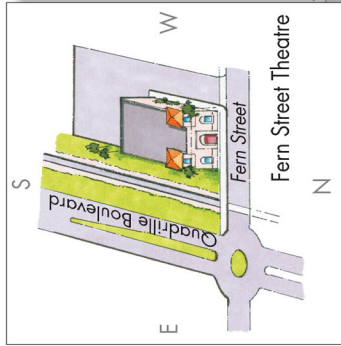

- ① Human Resources
- ② Okeechobee Hall
- ③ DeSantis Family Chapel
- ④ Pembroke Hall
- ⑤ Oceanview Hall/Dixie Garage
- ⑥ Baxter Residence Hall
- ⑦ Warren Library
- ⑧ Greene Complex for Sports and Recreation
- ⑨ Intramural Field
- ⑩ Vera Lea Rinker Hall
- ⑪ Gregory Hall
- ⑫ Admissions
- ⑬ Art Building
- ⑭ Information Village

- ⑮ Flagler Towers Residence Hall
- ⑯ Lakeview Residence Hall
- ⑰ Rinker School of Business/Residence Hall
- ⑱ MacArthur Hall
- ⑲ Johnson Residence Hall
- ⑳ Sachs Administration Building
- ㉑ Hood American Free Enterprise Building
- ㉒ Borbe Hall
- ★ Safety and Security
- ㉓ Weyenberg Residence Hall
- ㉔ Lassiter Student Center
- Ⓟ Visitor parking
- Ⓟ Parking
- Ⓟ Reserved parking

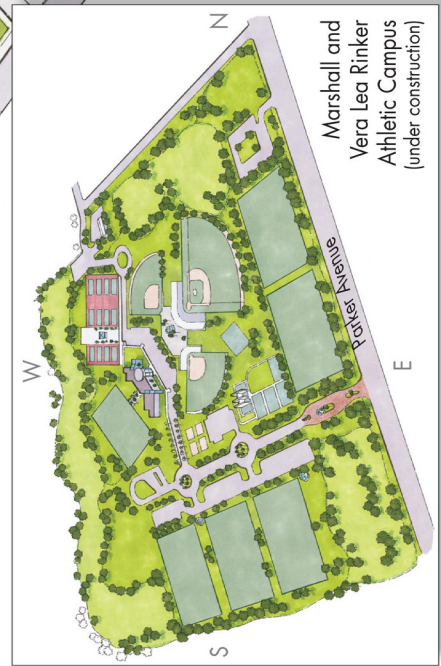

FORMS



XFUGE ON MISSION GROUP INFORMATION FORM

CHURCH NAME.....
GROUP LEADER NAME.....

Bring this sheet completed and the following items with you to registration:

- _____ Notarized Release Form for each student in alphabetical order.
- _____ Your completed Statement of Compliance.
- _____ Any Special Attention Cards you may have.
- _____ Sponsor's Children at Camp Agreement (if necessary)
- _____ Any payment for additional participants or last minute changes.

GROUP INFORMATION

Broken down by female and male:

Female Campers.....
Female Sponsors.....
Female College Students.....
Total Females.....

Male Campers.....
Male Sponsors.....
Male College Students.....
Total Males.....

Broken down by grade completed:

Completed 6th, 7th and 8th grades.....
Completed 9th and 10th grades.....
Completed 11th and 12th grades.....
College Students.....
Adult Sponsors (age 19 or older).....
Total.....



XFUGE ON MISSION AT CAMP REGISTRATION CHECKLIST

Please bring this with you on registration day. Below is a checklist to use during registration to ensure you have completed the registration process. As you and your group complete each task, simply place a check mark by that item on the list below.

- ☐ You have turned in your Group Information Form, verified registration numbers and either called 1.877.CAMP.123 to pay your balance or paid any additional amounts due to the Financial Director.
- ☐ You have turned in one set of notarized original Release Forms and photocopies of insurance cards.
- ☐ You and your drivers have met with the Site Director.
- ☐ You have received your group's room assignments and keys.
- ☐ Each student in your group has gone through the T-Shirt Station and taken one giveaway shirt.
- ☐ Your group has gotten their Church Group Photo taken.
- ☐ You have distributed room assignments and keys.
- ☐ Your group has located their rooms and moved in their belongings.
- ☐ You have attended the Group Leader Meeting before Opening Celebration.



SPECIAL ATTENTION CARD

CAMP LOCATION: _____ CAMP DATES: _____

Student Name: _____ Age: _____

Church Name: _____ Group Leader: _____

Bible Study Leader: _____

DESCRIPTION OF NEED: (use space below as needed)

Please provide information that will help us to better minister to this student. DO NOT disclose any confidential information.

FOR FUGE USE ONLY

Provide details of ways you ministered specifically to this student.

Provide any changes noted or actions taken on the part of the student.

Provide comments to group leader about this student.

STAFF SIGNATURE: _____ DATE: _____



Sponsor's Children at Camp Agreement

In an effort for everyone to have the best possible camp experience, please read and sign this statement in regard to having your child at camp this week.

Parent Name: _____

Camp Location & Week: _____

Parent Cell Phone Number: _____

I understand and agree to:

- Supervise my child at all times, or have someone from my church supervise my child when I cannot,
- Not allow my child to participate in any camp activities if they are under the age of 5,
- Follow the rules of the camp director in reference to what my child can or cannot do if they are age 6 or older, including but not limited to – only attending certain tracks and if attending ministry site must ride with the parent,
- Pay for my child if he/she will be using bed space or eating meals on campus,
- Not let my child distract others from camp experiences (i.e. worship services),
- Provide a FUGE Release Form for my child, no matter what their age,
- If my child is older than 6 years, he/she must stay in a dorm with boys if the child is a boy and girls if the child is a girl.

Signature: _____

Date: _____

Statement of Compliance:

This form is turned in upon arrival at camp.



The volunteering Adult Sponsors named below are known to the staff or recognized leadership of the participating church and the church knows of no reason why any should not serve as a sponsor for children and youth under the age of eighteen (18). The church confirms that it has taken reasonable steps to confirm that the individuals are not registered sex offenders by making inquiries to law enforcement officials or by checking www.nsopr.gov (the National Sex Offender Public Website). **In addition**, participating church warrants that it has used _____ company to perform nationwide criminal background checks on all Adult Sponsors. Participating church warrants it has brought no Adult Sponsor not listed on this form.

Here is a link to a LifeWay web site. Other reputable companies are acceptable to use.
<http://www.lifeway.com/Article/composite-home-background-checks> .

By signing this form you are stating that you have checked all adult sponsors will the national sex offender public website and ran a background check on each adult.

Names of all Adult Sponsors:

- | | |
|-----------|-----------|
| 1. _____ | 11. _____ |
| 2. _____ | 12. _____ |
| 3. _____ | 13. _____ |
| 4. _____ | 14. _____ |
| 5. _____ | 15. _____ |
| 6. _____ | 16. _____ |
| 7. _____ | 17. _____ |
| 8. _____ | 18. _____ |
| 9. _____ | 19. _____ |
| 10. _____ | 20. _____ |

For camps held in Texas, the sponsoring church attests that it has, in addition to the above referenced sex offender and criminal background checks, satisfied the requirements set forth by the Texas Department of State Health Services Rule 265.12, which can be found online at www.dshs.state.tx.us/youthcamp/default.shtm

Church Name: _____ Phone #: _____

Address: _____ City: _____ ST _____ ZIP _____

Authorized Representative Signature

Name Printed

Date



FUGE Release Form

Group Leaders: Bring ONE notarized copy of this document to registration and keep a photocopy for yourself to have with you in case of emergency at camp. Attach a photocopy of insurance card.

Church Information:

FUGE Venue: _____ Name of Church: _____
 Group Leader: _____ Group Leader's cell # at Camp: (____) _____
 Church Address: _____ City: _____ ST: _____ ZIP: _____

Camper's Info:

Participant Name _____ Age _____ Date of Birth: ____/____/____
 Grade Completed (*campers only*): _____ Address: _____ City: _____
 ST _____ ZIP _____ In case of an emergency notify: _____ Relationship to camper: _____
 Phone Numbers-Home: (____) _____ Work: (____) _____ Mobile: (____) _____ Other: (____) _____

Medical Profile

Generally, the participant's Health is: (Check One) ☐Excellent ☐Good ☐Fair ☐Poor

If Fair or Poor, please explain the condition: _____

List any medical difficulties which are currently being treated: _____

Check any of the following that cause you problems & explain: ☐Asthma ☐Sinusitis ☐Bronchitis ☐Kidney Trouble ☐Heart Trouble
☐Diabetes ☐Dizziness ☐Stomach Upset ☐Hay Fever _____

List any any medicines or substances to which you are allergic: _____

List any previous operations or serious illnesses _____

List any medications you are currently taking: _____

List any special diet or special needs: _____

Childhood Diseases: ☐Chickenpox ☐Measles ☐Mumps ☐Whooping Cough ☐Other: _____

Date of Tetanus Immunization: ____/____/____

Family Physician _____ Phone: (____) _____

Insurance Co. _____ Policy #: _____

Subscriber Name: _____ Subscriber Number: _____ Employment: _____

Subscriber Occupation: _____ Work Phone: (____) _____

Permission For Medical Treatment, Photograph/Video Notice, and Release and Indemnity

My permission is granted for the camp or event director, church official, any camp or event staffer, or adult present or in charge of first aid, to obtain necessary medical attention in case of sickness or injury to me or my child. Also, I understand that as a Participant, I or my child may be photographed or videotaped during normal camp or event activities, and these photos/videos may be used in promotional materials. I, the undersigned, do hereby verify that the above information is correct, and I do hereby release and forever discharge LifeWay Christian Resources of the Southern Baptist Convention, the FUGE Camp Venue, the Church, camp or event sponsors and state conventions and their employees ("Released Parties") from any and all claims, costs, demands, actions or causes of action, past, present or future arising out of any damage or injury in connection with my or my child's employment by or participation in this camp or event. I agree to indemnify the Released Parties for any and all claims, demands, damages, injuries, costs, suits or causes of action, past, present, or future, arising out of or caused by myself or by my child while participating in this camp or event or while on property leased or owned by any of the Released Parties.

Assumption of Risk. I am aware of the risks associated with participation in the above event and do hereby voluntarily assume full responsibility for any risk of loss, property damage or personal injury, including death, that may result from participation in event activities.

Recreation- The recreation programs at summer event venues strive to offer fun, safe, and challenging activities that engage the whole person—body, mind and soul. Program staffs are trained and as a team committed to your rewarding experience with safety as their highest priority. However there are inherent risks to participation in recreation activities, including but not limited to, initiative games, high and low challenge course, outdoor education, paintball, equestrian activities and aquatics, (not available at every FUGE venue). You could experience any of the following – elevated heart and respiratory rates, uncomfortable group dynamics, climbing or descending unpredictable and possibly slick or uneven terrain, crossing narrow wires and logs, jumping, running, climbing/descending steep rock faces, traveling long distances in remote settings, carrying weight on your backs and shoulders, unforeseen forces of nature or weather, any of which could result in injury/illness that could result in loss of life, limb, and/or property. For more detailed information about the recreation programs offered at summer event locations, go to www.FUGE.com and follow the specific link to the camp venue's Group Leader Information.

Understanding. I represent and acknowledge that I have completely read and understand this document and all its terms and all matters referred to herein, and I signed voluntarily as my free act and deed, that I have had an ample opportunity to obtain the advice of counsel and that, by signing this document, I understand that I am relinquishing legal rights and remedies that may have otherwise been available to me. I understand that this Waiver and Release shall be construed as broadly and inclusively as is permitted by applicable law and agree that if any portion of this document is held invalid, the remaining portions shall continue in full force and effect. To the extent the restriction on filing lawsuits is deemed unlawful, I agree to submit any Claims to a Christian conciliation/arbitration organization for binding resolution.

Copy to Camp Venue. It is understood and agreed that a copy of this form shall be treated as authentic and binding as the original and that a copy of same shall be provided to camp venue.

Complete and sign below (*participants who are minors per your state statute require Parent/Legal Guardian signature*).

Participant's Signature (only if 18 yrs of age or older): _____ Date: ____/____/____

Parent/ Guardian Signature: _____ Phone: (____) _____ Date: ____/____/____

Notary Acknowledgement: State of _____ County of _____ On _____
 before me, _____, Notary Public, personally appeared _____ who
 proved to me on the basis of satisfactory evidence to be the person(s) whose name(s) is/are subscribed to the within instrument and
 acknowledged to me that he/she/they executed the same in his/her/their signature(s) on the instrument the person(s), or the entity upon
 behalf of which the person(s) acted, executed the instrument.

I certify under PENALTY OF PERJURY under the laws of the state that the foregoing paragraph is true and correct.

WITNESS my hand and official seal.

Notary signature: _____ My commission expires: _____